

INSTALLER: Leave this manual with the appliance.
CONSUMER: Retain this manual for future reference.

These instructions are supplementary to the Installation and Operating Instructions supplied with the fireplace and should be kept together. Refer to the Installation and Operating Instructions for proper gas supply, safety requirements and operating instructions.



TOWN & COUNTRY
LUXURY FIREPLACES

TC42 TRANQUILITY BURNER KIT INSTALLATION INSTRUCTIONS



SKU# 22150039 &
22150034
For TC42 Series D
Fireplaces



Contents of Package

1 BURNER ASSEMBLY

1 PANEL, BASE

1 PEBBLE ASSEMBLY

1 COVER RHS

1 COVER LHS

3.4 LBS SAND

1 BAG TAPERED PLUGS



Tranquility Burner Installation

If converting to propane see conversion instructions on page #6 before proceeding.

NOTE: Plug the 4 vacant holes in the bottom of the firebox with 1/2" screws, as they are not required to attach this style of burner.

1. Bend flex lines into the approximate shape. (Fig #1)
2. Place covers under the burner tray. (Fig #2 & 3)

NOTE: Shutter must be fully closed for Natural gas, fully open for Propane.

Fig #1

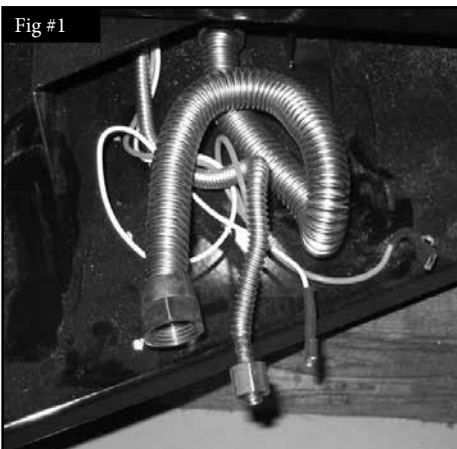

Fig #2

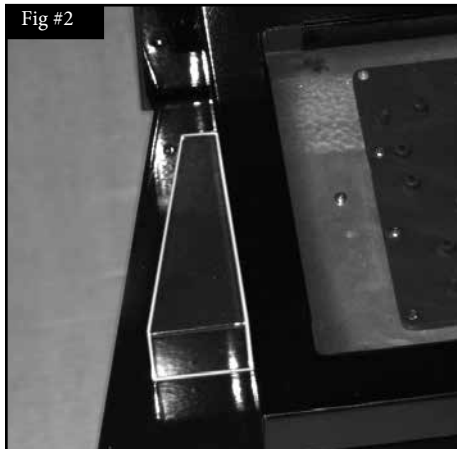
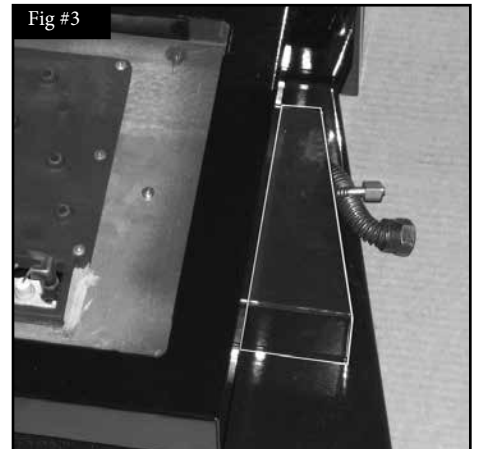

Fig #3



3. Position lower rear porcelain panel centered at the rear of the firebox. Place burner assembly into the firebox against the rear panel. (Fig #4)



Place panel clips under both rear corners of the base plate as shown in Fig. #4a (approx. 3" from rear panel).

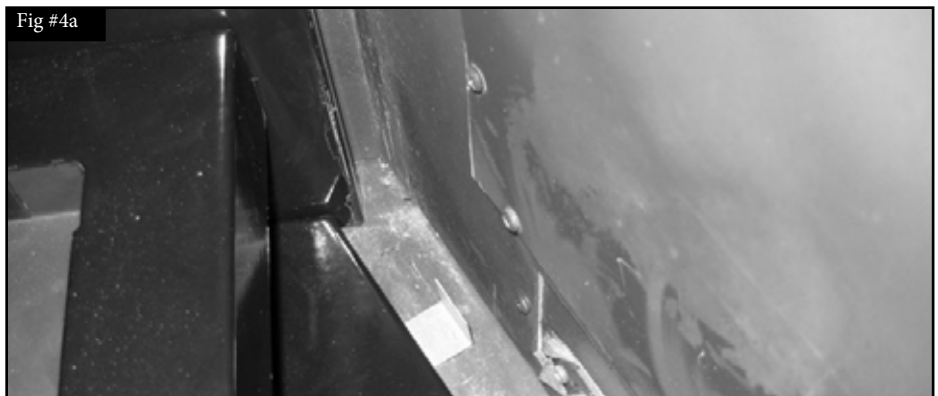

4. Attach the manifold supply tube and the pilot supply tube to the bulk head fittings and tighten. (Fig. #5) Ensure that there are no leaks.

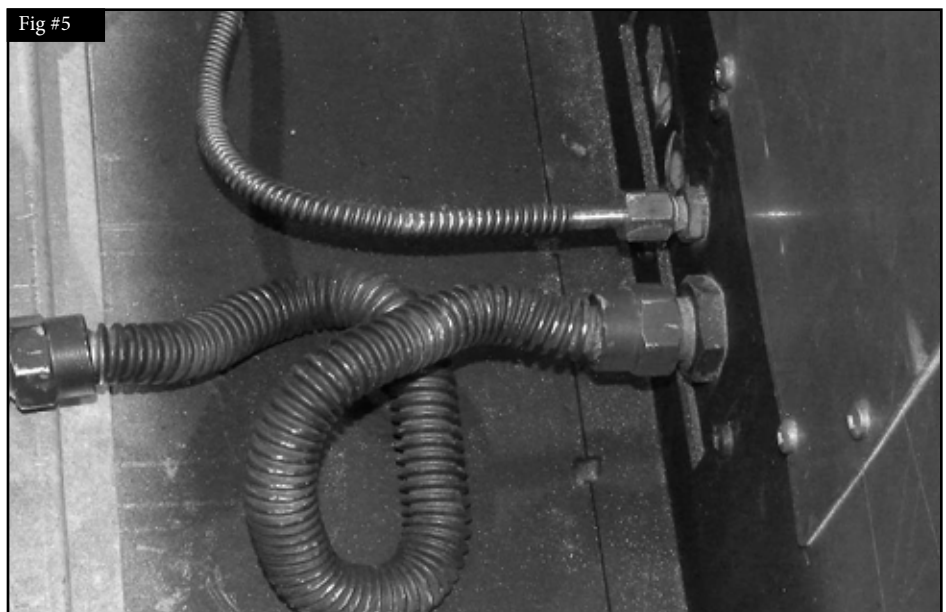

5. Secure the electrical bulkhead plate (Fig.#6) and gasket to the firebox. (2 screws) Attach the ignition and sensor wires to the module. (Fig.#7).

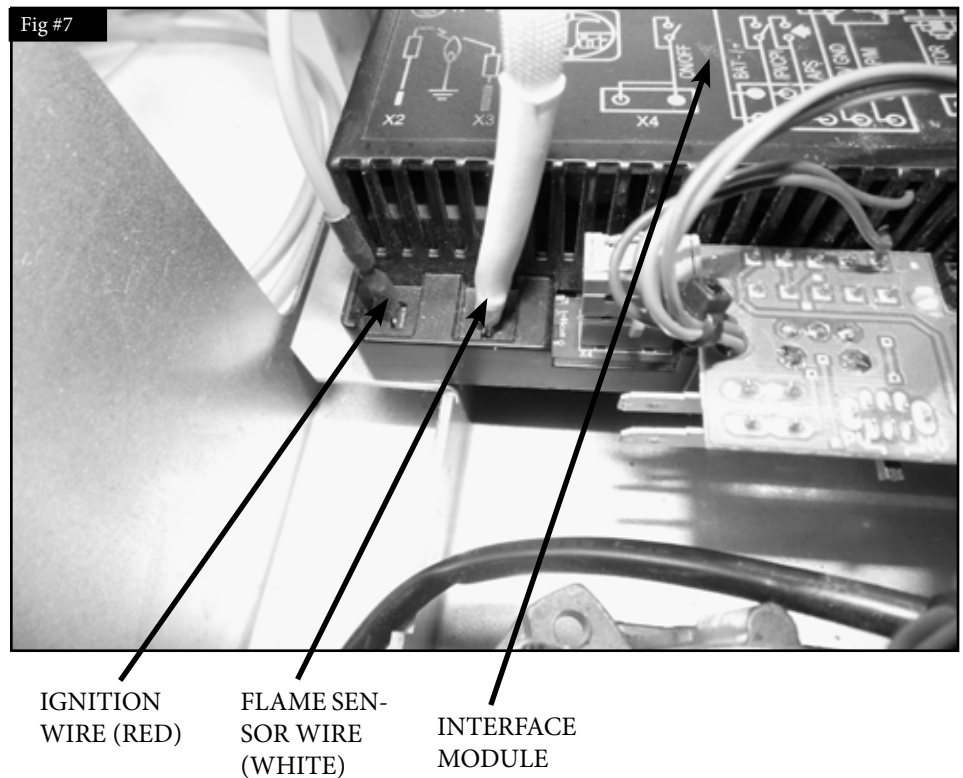
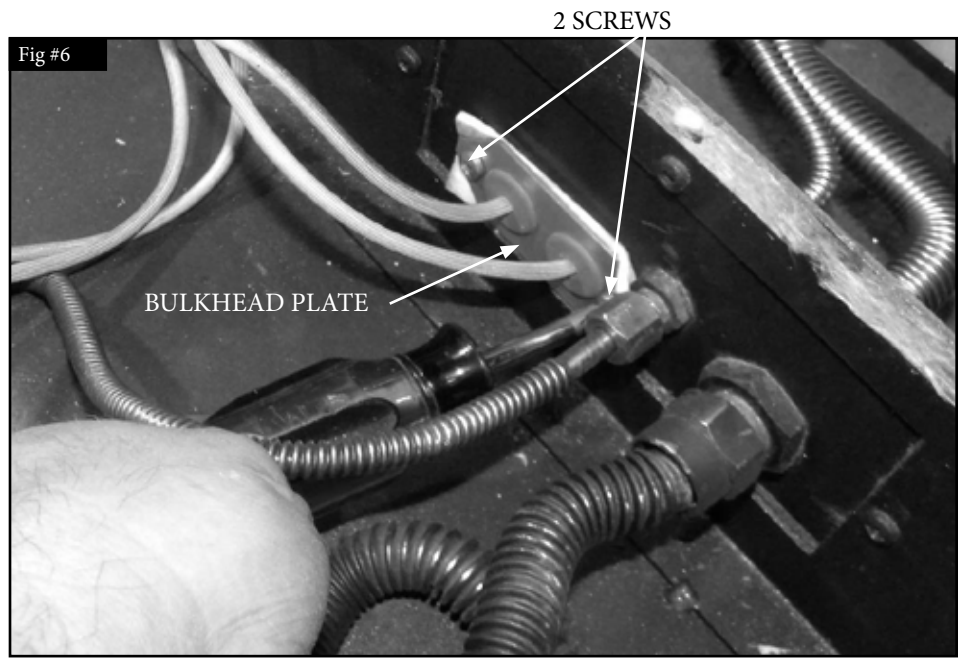

6. Remove panel retainer from upper heat shield. Install right porcelain panel tilting in from front corner. (Fig #8)



Slip the side panels into the panel clip as shown in Fig #9. Finish the installation as per instructions.

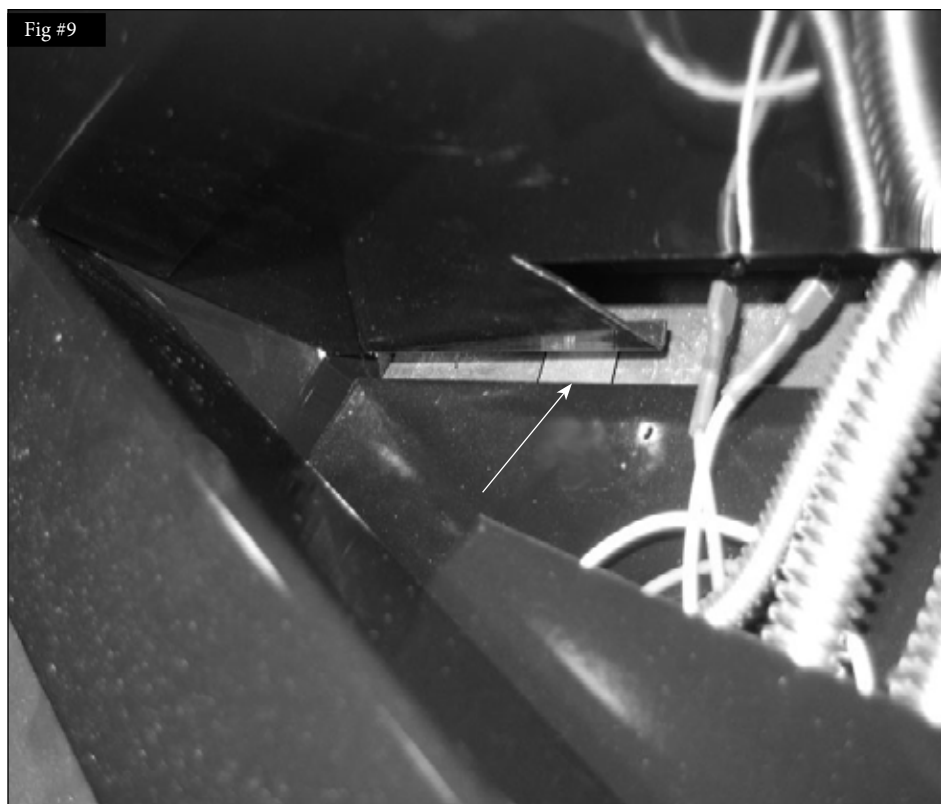

7. Position upper rear panel on the top of the lower rear panel and behind the right panel. While supporting the upper rear panel install and secure left porcelain panel in the same manner as the right panel. (Fig #10)
8. Secure with the previously removed panel retainer.



9. Slide covers out and attach to base with one screw each. (Fig #11)



10. Insert tapered plugs into raised burner ports to prevent sand from entering ports. (Fig #12)



11. Place sand in tray. Brush sand smooth and level to just below top of raised burner ports. (Fig #13)
12. Gently blow excess sand from around ports.
13. Remove tapered plugs from ports.



14. Remove pebble assembly from packaging by placing hand on top and tipping upside down. Gently place pebble assembly onto sand base using pins to locate position.
(Fig #14)

NOTE:

Lift pebble assembly from bottom.
Do not lift by top rocks.
Hollowed out rock must cover the pilot.

Fig #14



15. Place trim rocks at desired locations in the sand around the pebble assembly. Install glass door. Unit is ready for lighting.

NOTE:

Do not place trim rocks on top of the pebble assembly. Sooting will occur.

Fig #15



Propane Conversion

This appliance was converted to propane gas	
Kit Number	PACIFIC ENERGY
dd / mm / yy	5052.52001-B
Company	correction a été conversion a été responsabilité que cette ci-dessus accepte la l'entreprise désignée
Address	Adresse
The above accepts the responsibility that this conversion has been properly performed.	Firme
5052.52001-B	j / m / a
PACIFIC ENERGY	Numéro d'assemblage
Cet appareil a été converti en gaz propane	

CONVERSION LABEL (5052.52001-B)

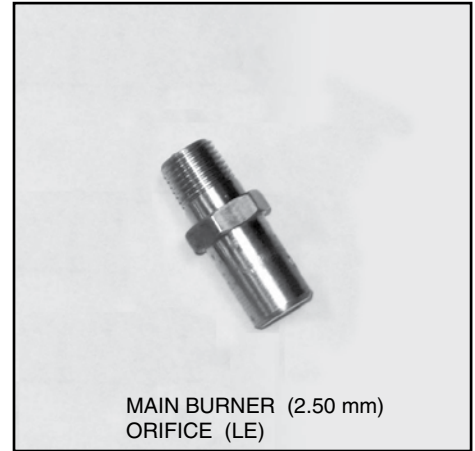

WARNING

This conversion kit shall be installed by a qualified service agency in accordance with the manufacturer's instructions and all applicable codes and requirements of the authority having jurisdiction.

If the information in these instructions is not followed exactly, a fire, explosion or production of carbon monoxide may result causing property damage, personal injury or loss of life.

The qualified service agency is responsible for the proper installation of this kit.

The installation is not proper and complete until the operation of the converted appliance is checked as specified in the manufacturer's instructions supplied with the kit.

If the unit is to be used on propane convert as follows using the components supplied with this burner:

CAUTION

The gas supply and electrical power shall be shut off before proceeding with the conversion.

Note: Factory supplied components must be used to ensure correct input.
After conversion confirm proper manifold pressure.

The burner assembly must be removed from the unit if previously installed.

1. Remove the 2 front screws holding the burner tray in place. (Fig. #16)
2. Gently lift up the burner tray while sliding to the left to disengage the burner tube from the orifice. Then tip back to expose the orifice.
3. Using a 1/2" wrench, undo the natural gas burner orifice. Apply a small amount of pipe joint compound to the threads of the propane burner orifice to ensure a good seal, before screwing it into the fitting. Loosen the primary air shutter screw, open shutter fully and re-tighten. (Fig. #17)
4. Remove the 2 screws holding the pilot assembly in place with a stubby screwdriver. (Fig #18)

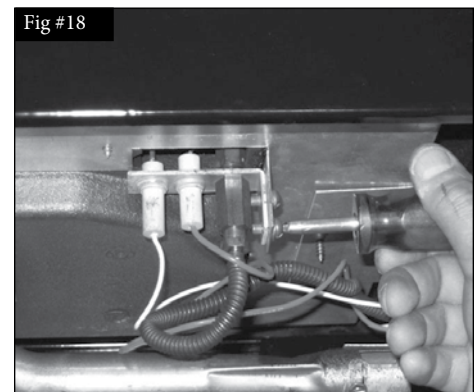
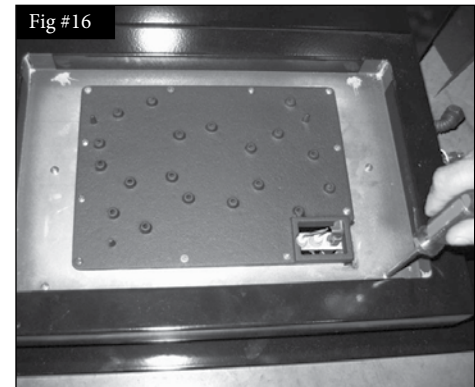



5. With a 7/16" wrench loosen the pilot head on the pilot assembly using a wrench to hold the bracket steady. (Fig. #19)

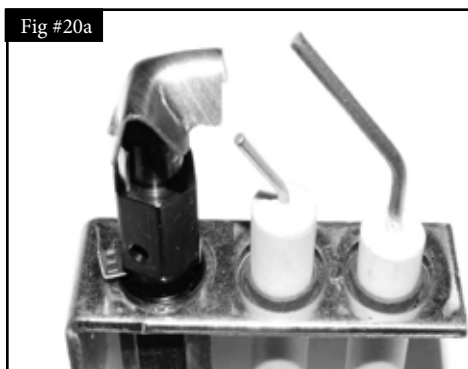

NG POSITION

6. Slide the pilot adjustment band over and ensure that the hole in the orifice band is showing.

◀ Fig. #20a shows NG position

Fig. #20b shows LP position). ▶

Re-attach the pilot assembly.

7. Remove the access panel, 10 screws, and set aside.

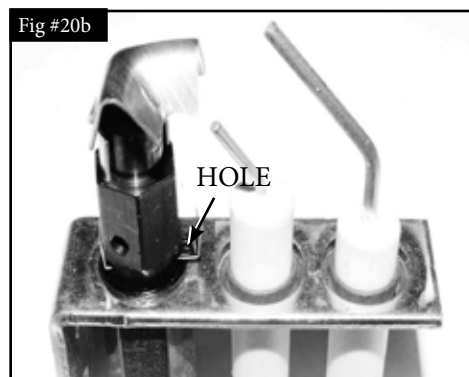

LP POSITION



8. Remove the minimum rate screw located in the valve. (Fig. #21)

The minimum rate screw is sealed with an o-ring. Use a thin bladed screwdriver to back the screw out past the limit of the threading. At this point a groove on the screw body will be visible just above the valve body. Insert a thin tool (knife blade or fine screwdriver blade) into the groove and gently pry the screw up.

9. Fill in the conversion label. Peel off the protective backing and apply the conversion label directly over the gas specifications on the rating label. Rating label can be found on a metal plate stored on the left hand side of the fireplace, behind the decorative trim.

For complete valve installation instructions, refer to the instruction book included in the SIT conversion kit.

Burner Flame Adjustment

The air shutter on the burner inlet tube controls the primary combustion air. It is set to the closed position at the factory for natural gas fuel. Some adjustment may be necessary to obtain desired flame and to eliminate carbon deposits. Evaluate flame appearance after the fireplace has reached operating temperature. See Fig. #22 for proper flame pattern.

Open primary air if the window glass and firebox have carbon accumulation and/or the flames are long, dark and stringy. The shutter may also be opened to lessen the flame height.

Fig #22



NOTE:

Proper air shutter setting is required.

For Propane the primary shutter must be fully open.

The flame should be just orange and “lazy”. It should NEVER be set to create sooting on internal parts and window glass.

Replacement Parts

(WHEN ORDERING, INCLUDE PART NUMBER WITH DESCRIPTION)

ITEM.....	DESCRIPTION.....	PART NO.
#1	TRANQUILITY BURNER KIT	SKU#22150039
 (Black), SKU# 22150034 (Brown)	
#2	PEBBLE ASSEMBLY	TC42.9499
#3	MAIN SUPPLY TUBE	5019.223
#4	PILOT TUBE.....	5019.225

ITEM.....	DESCRIPTION.....	PART NO.
#5	PILOT ASSEMBLY, CONVERTIBLE	TCRP.5005025
#6	ORIFICE, NATURAL GAS (#25).....	5022.12
★ #7	PROPANE CONVERSION KIT	TC42.LPCE01
★ #8	SAND	TC42.SAND34

★ NOT SHOWN

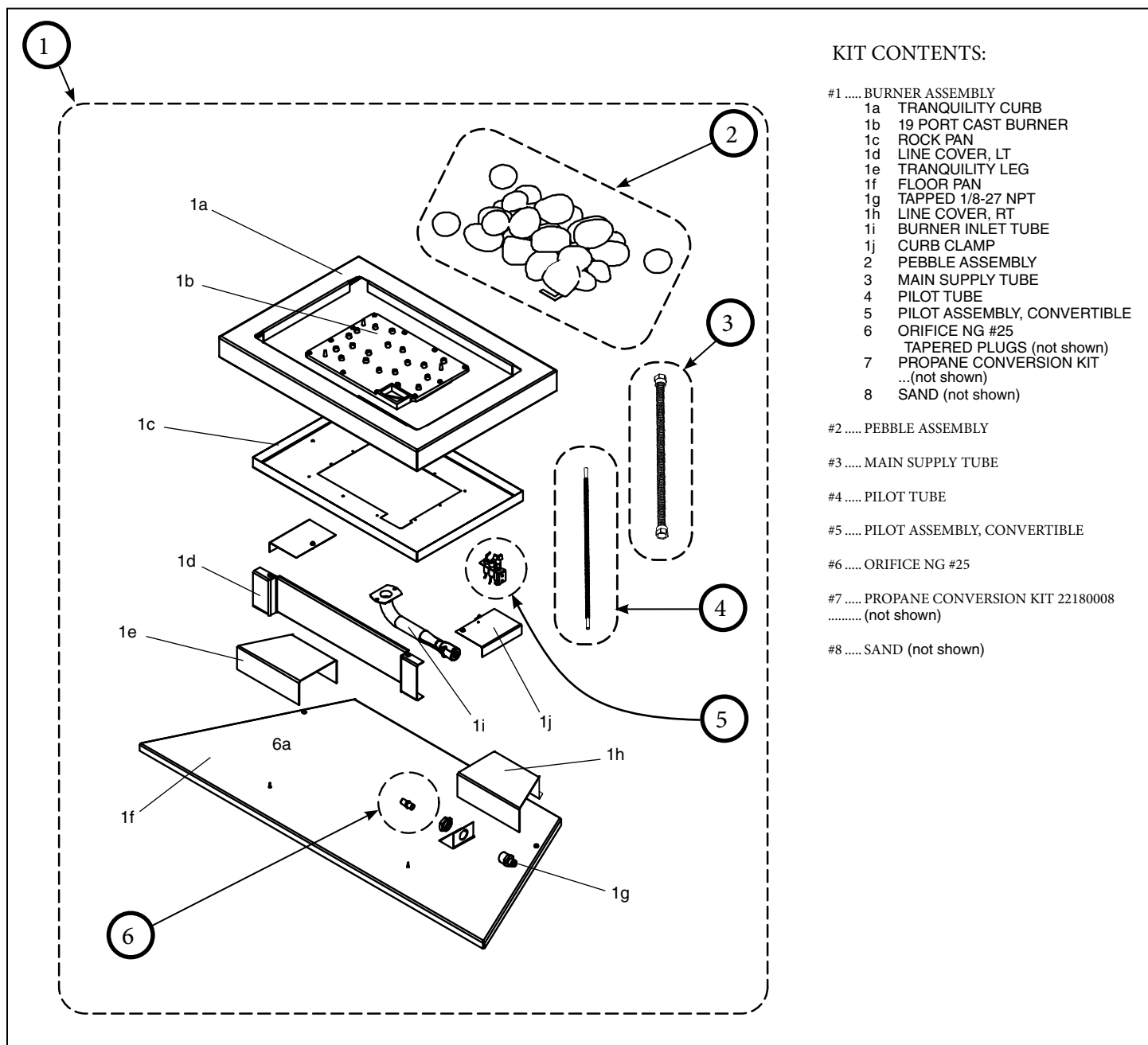

Reproduction, adaptation, or translation
without prior written permission is prohibited,
except as allowed under the copyright laws.



For technical support, please contact your retailer.

Web site: www.townandcountryfireplaces.net
2975 Allenby Rd., Duncan, BC V9L 6V8